

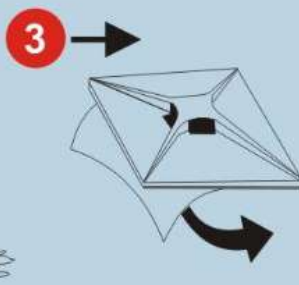

Clean surface with a clean cloth and isopropyl alcohol.



Allow surface to air dry.



Remove the release liner, being careful not to touch the adhesive.



Apply full thumb pressure for at least 5 seconds.



Allow mount to properly dwell.

HOW TO INSTALL A CABLE GLAND

1 PREPARE THE PARTS



- Check all components: gland body, sealing insert, O-ring and dome nut.

2 PREPARE THE CABLE



- Strip the cable outer jacket as required.
- Ensure the cable is clean and free from damage.

3 ASSEMBLE THE GLAND



- Pass the dome nut and sealing insert over the cable.
- Ensure the sealing insert is oriented as shown.

4 INSERT GLAND BODY



- Insert the gland body with O-ring into the enclosure/panel hole from the outside.
- Ensure the O-ring sits flat against the surface for proper sealing.

5 SECURE WITH LOCKNUT



- From inside the panel, fit the locknut and tighten it.
- Use hand or wrench to secure the gland body firmly in place.

6 INSERT THE CABLE



- Feed the cable through the gland body until sufficient length remains inside.

7 TIGHTEN THE DOME NUT



- Slide the sealing insert forward (if required) and tighten the dome nut.
- Tighten until the insert compresses and grips the cable securely. Do not over-tighten.

8 INSTALLATION COMPLETE



- The cable gland is now properly installed, providing a secure, waterproof and strain-relief cable entry.

BENEFITS

- Secure • Waterproof • Dustproof • Strain Relief



NOTE: Ensure correct gland size is selected for the cable diameter. Always maintain proper tightening for optimum performance.



IP68
PROTECTION



STRAIN
RELIEF

HOW TO INSTALL A CABLE TIE

1 PLACE



Place the cable tie around the cable bundle and insert the tail into the head.

2 PULL



Pull the tail through the locking head and tighten it down to secure the bundle.

3 CUT



Cut the excess tail using a cable tie tool or **scissor** for a neat and compact finish.



INSTALLATION COMPLETE



RECOMMENDED TOOL



NOVOFLEX CABLE TIE TENSION TOOL (TG-02) (METAL BODY)

For fixing upto 8 mm wide Nylon Cable Ties.

IDEAL STORAGE CONDITIONS



50% Relative Humidity

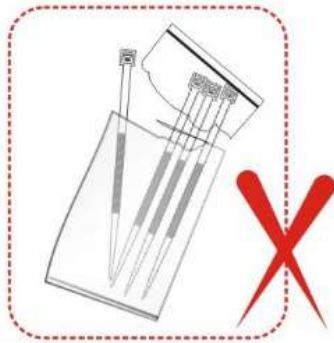

Once opened you should use the ties as quickly as possible.

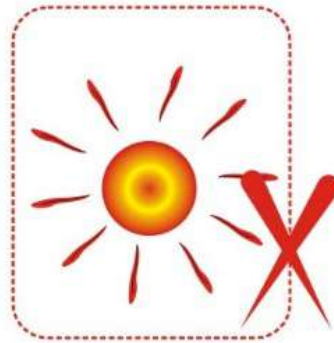

Do not expose the product to direct sunlight.



Store the product away from direct sources of heat.